

A 141 - P 141

P L A S M A R A N G E

TECHNICAL DATA

| | |
|-------------------|-----------|
| Voltage class | M |
| Standard length m | 6 |
| Air consumption | 210 l/min |
| Air pressure | 5 bar |
| Duty cycle 60% | 140 A |
| Duty cycle 100% | 100 A |

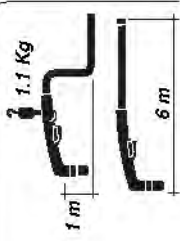

| | A 141 | m | | P 141 | m |
|-------------------------|--------|----|-------------------------|--------|----|
| FITTING | PA1502 | 6 | FITTING | PA0103 | 6 |
| 1/4 G | PA1500 | 6 | 1/4 GXT | PA0104 | 12 |
| FITTING | PA1501 | 12 | PA0145 | 6 | |
| 1/4 GXT | PA1504 | 6 | PA0146 | 12 | |
| Central adaptors | PA1505 | 12 | Central adaptors | | |

DECLARATION OF CONFORMITY

The undersigned company Trafimet - Via del Lavoro, 8 - 36020 Castegnero (VI) - Italy - declares that the product identified and described on this page complies with standard EN 60974-7 in accordance with the requirements contemplated by directive EEC 73/23 low voltage.



EN 60974-7

trafimet
your welding partner

A 141 - P 141

P L A S M A R A N G E

COMPLETE CABLE

| | | |
|--------|-----------------|-----|
| PH0240 | M14x1 | 6m |
| PH0242 | 1/4 G | 6m |
| PH0149 | central adaptor | 6m |
| PH0151 | central adaptor | 12m |

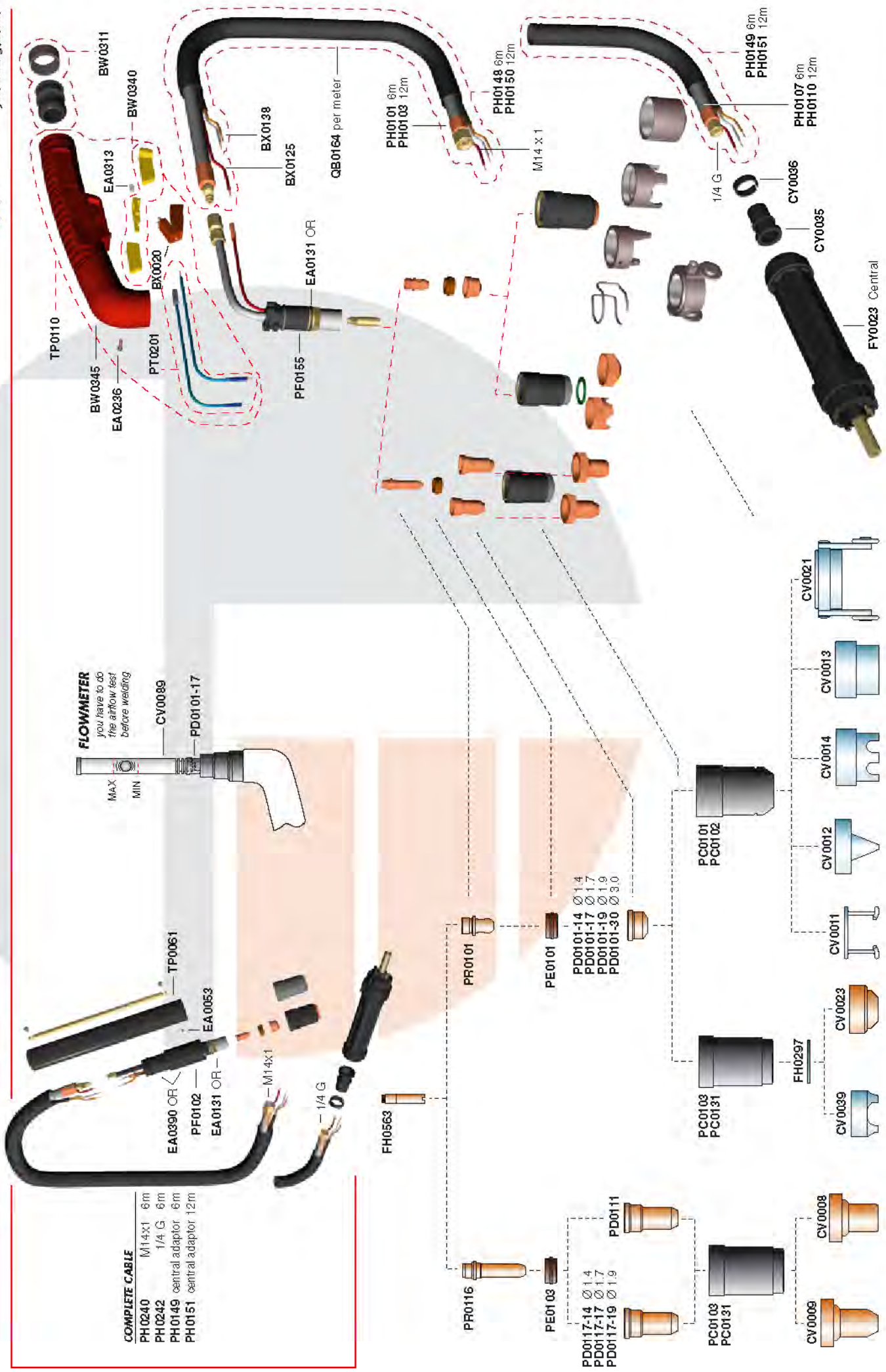

FLOWMETER
you have to do
the airflow test
before welding



The company reserve the right to modify any products without notice. TRAFIMET spa is the registered owner of all trademarks, patents and models.



trafimet
your welding partner

Copyright © 2002 Trafimet Spa. All rights reserved.
Print date 11/04 - EA0362



www.trafimet.com

PLASMATOORTS A 141

| artikelnummer Leverancier | Tramex | Omschrijving | Type |
|------------------------------|-------------------|---------------------------|----------------------|
| PA1502 | 2512630385 | Plasma snijtoorts 6 mtr. | Ergocut A 141 1/4G |
| PA1500 | 2512630380 | Plasma snijtoorts 6 mtr. | Ergocut A 141 M14x1 |
| PA1501 | 2512630383 | Plasma snijtoorts 12 mtr. | Ergocut A 141 M14x1 |
| PA1504 | 2512630387 | Plasma snijtoorts 6 mtr. | Ergocut A 141 C.A. |
| PA1505 | 2512630389 | Plasma snijtoorts 12 mtr. | Ergocut A 141 C.A. |
| FH0563 | 2522632470 | Luchtgeleidingsbuisje | A141+A151 |
| PR0101 | 2522632304 | Snij-electrode | A101+A141+P141 |
| PE0101 | 2522632305 | Luchtverdeler | A101+A141+P141 |
| PD0101-14 | 2522632307 | Snijmondstuk 1.4 | A101+A141+P141 |
| PD0101-17 | 2522632308 | Snijmondstuk 1.7 | A101+A141+P141 |
| PD0101-19 | 2522632409 | Snijmondstuk 1,9 | A141+P141 |
| PD0101-30 | 2522632410 | Gutsmondstuk 3,0 | A 141 |
| PC0103 | 2522632413 | Gasmondstuk met contact | A141 |
| PC0131 | 2522632414 | Gasmondstuk, versterkt | A141+A151 |
| FH0297 | 2522632328 | Isolatie voor CV 39 | A101+A141 |
| CV0039 | 2522632416 | Afstandsbus rechte punten | A101+A141 |
| CV0023 | 2522632311 | Afstandsbus geb.punten | A101+A141 |
| PC0101 | 2522632411 | Gasmondstuk | A141+P141 |
| PC0102 | 2522632412 | Gasmondstuk, versterkt | A141+P141 |
| CV0011 | 2522632312 | Afstandsveer | Diverse toortsen |
| CV0012 | 2522632313 | Afstandsbus 2-poots | Diverse toortsen |
| CV0014 | 2522632314 | Afstandsbus 4-poots | A101+A141+A151+PW180 |
| CV0013 | 2522632417 | Guts-afstandsbus | A140+PW180 |
| CV0021 | 2522632321 | Snijwagen | Diverse toortsen |
| PR0116 | 2522632340 | Snij-electrode lang | A101+A141+A151 |
| PE0103 | 2522632507 | Luchtverdeler | A101+A151 |
| PD0117-14 | 2522632345 | Snijmondstuk 90A | A101+A141+A151 |
| PD0117-17 | 2522632346 | Snijmondstuk 120A | A101+A141+A151 |
| PD0117-19 | 2522632347 | Snijmondstuk 150A | A101+A141+A151 |
| PD0111-12 | 2522632342 | Snijmondstuk lang 50A | A101+A151 |
| PC0103 | 2522632413 | Gasmondstuk met contact | A141 |
| PC0131 | 2522632414 | Gasmondstuk, versterkt | A141+A151 |
| CV0009 | 2522632349 | Afst.cup-kontaktsnijden | A101+A141+A151 |
| CV0008 | 2522632348 | Afst.cup-kontaktsnijden | A101+A141+A151 |
| TP0110 | 2522632240 | Handgreep Kpl. | A81+A101+A141+A151 |
| BW0345 | 2522632243 | Handgreep, los | A81+A101+A141+A151 |
| EA0236 | 2522632064 | Inzetschroeven handgreep | Diverse plasma |
| BX0020 | 2162609021 | Drukschakelaar | Diverse toortsen |
| EA0313 | 2522632214 | Veer | Diverse plasma |
| BW0340 | 2522632213 | Beveiliging tbv schakelaa | A81+A101+A141+A151 |
| BW0311 | 2342640210 | Kogelgewricht + ring | Diverse toortsen |
| PF0155 | 2522632469 | Branderlichaam | A 141 |
| EA0131 | 2522632302 | O-Ring | Diverse toortsen |
| BX0125 | 2552650298 | Kabelpilotboog | CB 50 |
| BX0138 | 2522632079 | Controle kabel | S 45 |

PLASMATOORTS A 141

| Leverancier | artikelnummer Tramex | Omschrijving | Type |
|-------------|-------------------------|---------------------------|------------------|
| PH0101 | 2522632430 | Stroom-luchtkabel 6 mtr. | A141+A151+P141 |
| PH0103 | 2522632431 | Stroom-luchtkabel 12 mtr. | A141+A151+P141 |
| PH0148 | 2522632473 | Toortspakket 6M M14x1 | A 141 + A 151 |
| PH0150 | 2522632395 | Toortspakket 12M M14x1 | Ergocut A141 |
| PH0149 | 2522632394 | Toortspakket 6M CA | Autocut P141 |
| PH0151 | 2522632396 | Toortspakket 12M CA | Ergocut A141 |
| PH0107 | 2522632445 | Stroom-luchtkabel 6mtr. | A 141 |
| PH0110 | 2522632446 | Stroom-luchtkabel 12 mtr. | A 141 |
| CV0036 | 2552650263 | Cirkelsnijbranderset kpl. | CB30-35 |
| CY0035 | 2522632443 | Buigbescherming handgreep | A141+A151 |
| FY0023 | 2522632130 | C.A. 5-pins Kpl. T.Z. | Diverse plasma |
| CV0089 | 2522632460 | Flowmeter | A 141 |
| CV0022 | 2522632322 | Snijwagen-passer-set | Diverse toortsen |
| PT0220 | * 2522632461 | Ombouwset handreep compl. | A 141 |

* = niet afgebeeld.

PLASMATOORTS P 141

| artikelnummer Leverancier | Tramex | Omschrijving | Type |
|------------------------------|-------------------|---------------------------|----------------------|
| PA0145 | 2512630410 | Plasma AUT.toorts 6 mtr. | Autocut P 141 CA |
| FH0563 | 2522632470 | Luchtgeleidingsbuisje | A141+A151 |
| PR0101 | 2522632304 | Snij-electrode | A101+A141+P141 |
| PE0101 | 2522632305 | Luchtverdeler | A101+A141+P141 |
| PD0101-14 | 2522632307 | Snijmondstuk 1.4 | A101+A141+P141 |
| PD0101-17 | 2522632308 | Snijmondstuk 1.7 | A101+A141+P141 |
| PD0101-19 | 2522632409 | Snijmondstuk 1,9 | A141+P141 |
| PD0101-30 | 2522632410 | Gutsmondstuk 3,0 | A 141 |
| PC0103 | 2522632413 | Gasmondstuk met contact | A141 |
| PC0131 | 2522632414 | Gasmondstuk, versterkt | A141+A151 |
| FH0297 | 2522632328 | Isolatie ring voor CV 39 | A101+A141 |
| CV0039 | 2522632416 | Afstandsbus rechte punten | A101+A141 |
| CV0023 | 2522632311 | Afstandsbus geb.punten | A101+A141 |
| PC0101 | 2522632411 | Gasmondstuk | A141+P141 |
| PC0102 | 2522632412 | Gasmondstuk, versterkt | A141+P141 |
| CV0011 | 2522632312 | Afstandsveer | Diverse toortsen |
| CV0012 | 2522632313 | Afstandsbus 2-poots | Diverse toortsen |
| CV0014 | 2522632314 | Afstandsbus 4-poots | A101+A141+A151+PW180 |
| CV0013 | 2522632417 | Guts-afstandsbus | A140+PW180 |
| CV0021 | 2522632321 | Snijwagen | Diverse toortsen |
| PR0116 | 2522632340 | Snij-electrode lang | A101+A141+A151 |
| PE0103 | 2522632507 | Luchtverdeler | A101+A151 |
| PD0117-14 | 2522632345 | Snijmondstuk 90A | A101+A141+A151 |
| PD0117-17 | 2522632346 | Snijmondstuk 120A | A101+A141+A151 |
| PD0117-19 | 2522632347 | Snijmondstuk 150A | A101+A141+A151 |
| PD0111-12 | 2522632342 | Snijmondstuk lang 50A | A101+A151 |
| PC0103 | 2522632413 | Gasmondstuk met contact | A141 |
| PC0131 | 2522632414 | Gasmondstuk, versterkt | A141+A151 |
| CV0009 | 2522632349 | Afst.cup-kontaktsnijden | A101+A141+A151 |
| CV0008 | 2522632348 | Afst.cup-kontaktsnijden | A101+A141+A151 |
| PF0102 | 2522632475 | Branderlichaam | P 141 |
| EA0131 | 2522632302 | O-Ring | Diverse toortsen |
| TP0061 | 2522632281 | Handgreep | Diverse toortsen |
| FH0158 | 2522632285 | Tandheugel | Diverse toortsen |
| PH0240 | 2522632481 | Toortspak.6M M14x1 afges. | P 141 |
| PH0242 | 2522632482 | Toortspak.6M 1/4" afgesch | P 141 |
| PH0149 | 2522632394 | Toortspakket 6M CA | Autocut P141 |
| PH0151 | 2522632396 | Toortspakket 12M CA | Ergocut A141 |
| CV0089 | 2522632460 | Flowmeter | A 141 |

* = niet afgebeeld.